

Parts & Hardware

- A** (3) Top Legs (two angled ends, one straight)
- B** (3) Bottom Legs (with foot pads)
- C** (1) Easel Support Tray
- D** (1) Tray Cross Brace
- E** (3) Leg Bolt Assembly (short)
- F** (1) Top Bolt Assembly (medium)
- G** (1) Tray Bolt Assembly (long)
- H** (1) Leg Chain

Carefully check contents of box to ensure no parts are missing.

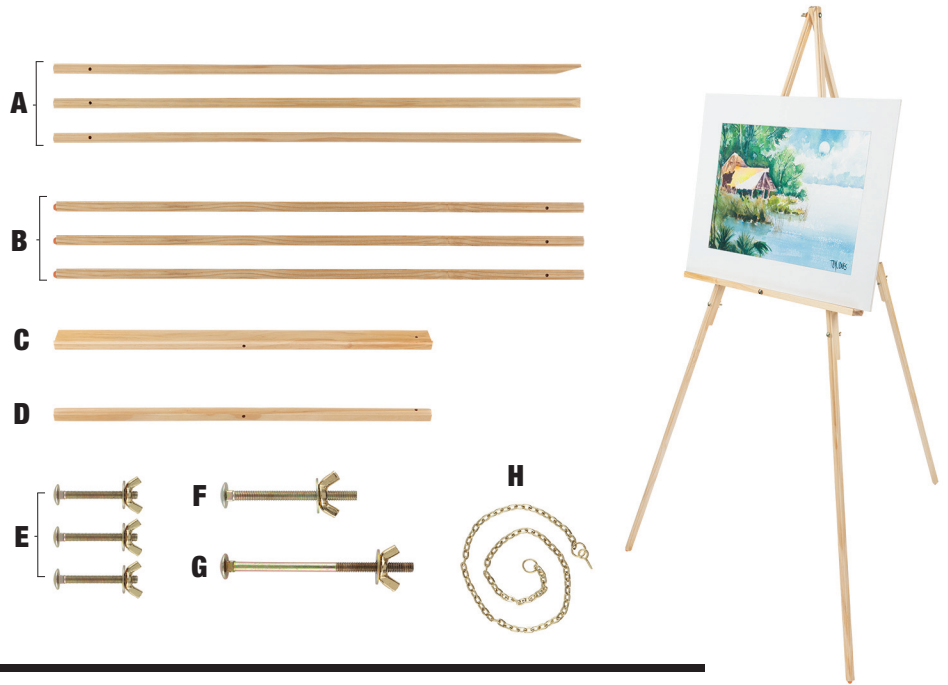

Assembly Instructions

Please review all instructions before proceeding.

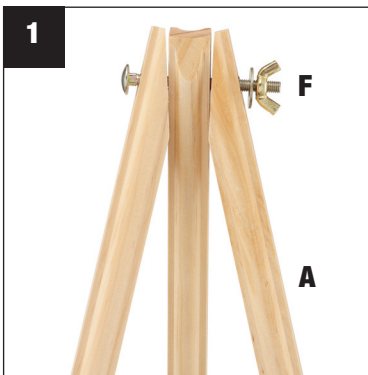

Face the angled ends of the Top Legs (**A**) toward each other with the straight one in the middle to create a triangle. Use the Top Bolt Assembly (**F**) to loosely connect all three legs at the top.

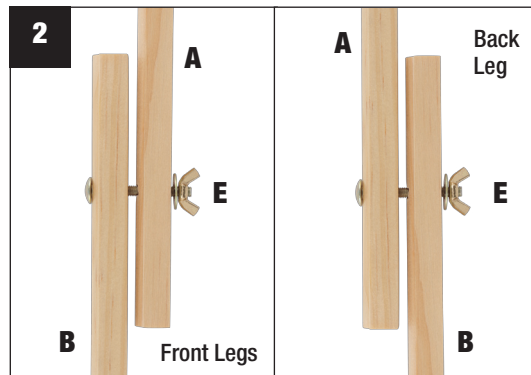

Place two Bottom Legs (**B**) *in front of* the outer Top Legs (**A**) and loosely connect each leg using the Leg Bolt Assembly (**E**). Place the third Bottom Leg *behind* the center Top Leg (**A**) and loosely connect them using the remaining Leg Bolt Assembly (**E**).

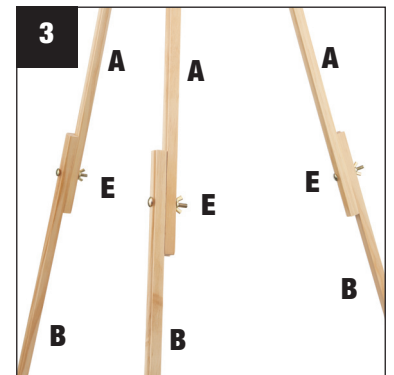

Tighten all wing nuts at this time. Stand the assembly and tilt the center leg backward and the outside legs toward the front to stand as a tripod.

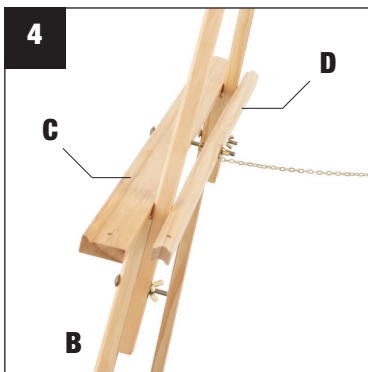

Hold the Easel Support Tray (**C**) in front of the two front legs. It can rest on top of the Bottom Legs (**B**).

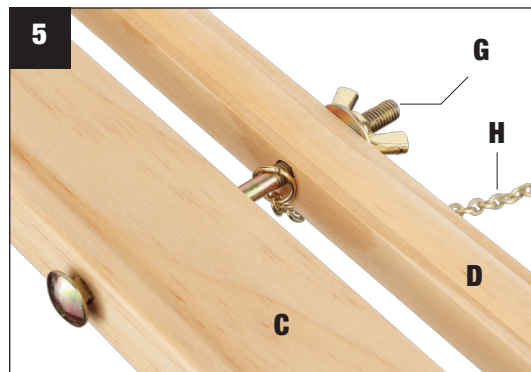

Thread the Tray Bolt (**G**) through the middle hole. Locate the end of the Leg Chain (**H**) with no screw eye and slide onto the bolt, then slide on the Tray Cross Brace (**D**) behind the legs. Attach washer and wing nut and tighten.

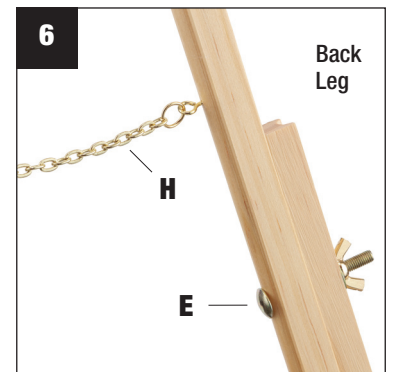

At the other end of the Leg Chain (**H**), push and turn the screw eye into the wood of the center back leg just above the Leg Bolt Assembly (**E**).